

Aseptic fittings for Orbital welding DIN 11865

Art.No

EUR

Art.No

EUR

Reducing cross piece ASME, H3

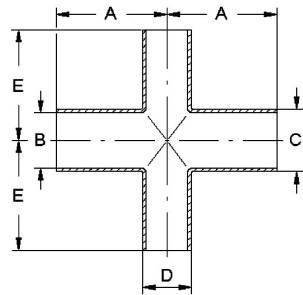

DN	A	B	C	D	E			AISI316L-1.4435
3/4"-1/2"	51	15,75	19,05	12,7x1,65	51			489705 Enquiry
1"-1/2"	54	22,1	25,4	12,7x1,65	54			489706 Enquiry
1"-3/4"	54	22,1	25,4	19,05x1,65	54			489707 Enquiry
1,5"-3/4"	60,3	34,8	38,1	19,05x1,65	60,3			489708 Enquiry
1,5"-1"	60,3	34,8	38,1	25,4x1,65	60,3			489716 Enquiry
2"-1"	73	47,5	50,8	25,4x1,65	65			489718 Enquiry
2"-1,5"	73	47,5	50,8	38,1x1,65	65			489719 Enquiry
2,5"-1"	80	60,2	63,5	25,4x1,65	73			489709 Enquiry
2,5"-1,5"	80	60,2	63,5	38,1x1,65	73			489720 Enquiry
2,5"-2"	80	60,2	63,5	50,8x1,65	73			489721 Enquiry
3"-1,5"	85	72,9	76,2	38,1x1,65	80			489722 Enquiry
3"-2"	85	72,9	76,2	50,8x1,65	80			489723 Enquiry
3"-2,5"	85	72,9	76,2	63,5x1,65	80			489724 Enquiry
4"-2"	105	97,38	101,6	50,8x1,65	100			489710 Enquiry
4"-2,5"	105	97,38	101,6	63,5x1,65	100			489725 Enquiry
4"-3"	105	97,38	101,6	76,2x1,65	100			489726 Enquiry

Similar to DIN 11865

Reducing cross piece ISO, H3

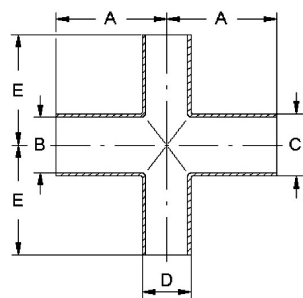

DN	A	B	C	D	E			AISI316L-1.4435
10-8	34	14	17,2	13,5x1,6	34			489829 Enquiry
15-10	36	18,1	21,3	17,2x1,6	36			489859 Enquiry
20-10	55	23,7	26,9	17,2x1,6	55			489860 Enquiry
20-15	55	23,7	26,9	21,3x1,6	55			489861 Enquiry
25-10	60	29,7	33,7	17,2x1,6	60			489862 Enquiry
25-15	60	29,7	33,7	21,3x1,6	60			489863 Enquiry
25-20	60	29,7	33,7	26,9x1,6	60			489864 Enquiry
32-15	65	38,4	42,4	21,3x1,6	65			489865 Enquiry
32-20	65	38,4	42,4	26,9x1,6	65			489866 Enquiry
32-25	65	38,4	42,4	33,7x2	65			489867 Enquiry
40-15	65	44,3	48,3	21,3x1,6	65			489868 Enquiry
40-20	65	44,3	48,3	26,9x1,6	65			489869 Enquiry
40-25	65	44,3	48,3	33,7x2	65			489870 Enquiry
40-32	65	44,3	48,3	42,4x2	65			489871 Enquiry
50-15	90	56,3	60,3	21,3x1,6	90			489834 Enquiry
50-20	90	56,3	60,3	26,9x1,6	90			489835 Enquiry
50-25	90	56,3	60,3	33,7x2	90			489872 Enquiry
50-32	90	56,3	60,3	42,4x2	90			489873 Enquiry
50-40	90	56,3	60,3	48,3x2	90			489874 Enquiry
65-25	110	72,1	76,1	33,7x2	90			489875 Enquiry
65-32	110	72,1	76,1	42,4x2	90			489876 Enquiry
65-40	110	72,1	76,1	48,3x2	90			489877 Enquiry
65-50	110	72,1	76,1	60,3x2	90			489878 Enquiry
80-25	130	84,3	88,9	33,7x2	110			489879 Enquiry
80-32	130	84,3	88,9	42,4x2	110			489880 Enquiry
80-40	130	84,3	88,9	48,3x2	110			489881 Enquiry

Similar to DIN 11865

LINNEMANN
Rohrverbindungen • Edelstahlarmaturen
Pipe connections • Stainless steel fittings

LINNEMANN GmbH • Heerweg 14-16
72070 Tübingen / Germany

Fon: +49 (0) 7071 97555-0
Fax: +49 (0) 7071 97555-10

E-Mail: info@linnemann-online.com
Internet: www.linnemann-online.com

Aseptic fittings for Orbital welding DIN 11865

Art.No

EUR

Art.No

EUR

Reducing cross piece ISO, H3

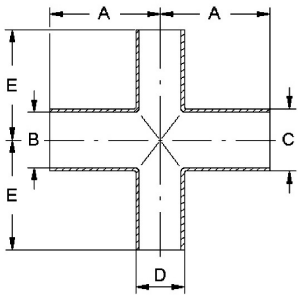

DN	A	B	C	D	E	Art.No	EUR	AISI316L-1.4435	EUR
80-50	130	84,3	88,9	60,3x2	110			489882	Enquiry
80-65	130	84,3	88,9	76,1x2	110			489883	Enquiry
100-50	160	109,7	114,3	60,3x2	130			489884	Enquiry
100-65	160	109,7	114,3	76,1x2	130			489885	Enquiry
100-80	160	109,7	114,3	88,9x2,3	130			489886	Enquiry

Similar to DIN 11865

Reducing cross piece DIN, short, H3

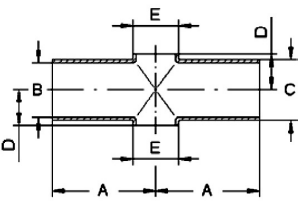

DN	A	B	C	D	E	Art.No	EUR	AISI316L-1.4435	EUR
15-10	35	16	19	11	13x1,5			489959	Enquiry
20-10	40	20	23	13	13x1,5			489960	Enquiry
20-15	40	20	23	13	19x1,5			489961	Enquiry
25-10	50	26	29	16	13x1,5			489962	Enquiry
25-15	50	26	29	16	19x1,5			489963	Enquiry
25-20	50	26	29	16	23x1,5			489964	Enquiry
32-15	55	32	35	19,5	19x1,5			489965	Enquiry
32-20	55	32	35	19,5	23x1,5			489966	Enquiry
32-25	55	32	35	19,5	29x1,5			489967	Enquiry
40-15	60	38	41	23	19x1,5			489968	Enquiry
40-20	60	38	41	23	23x1,5			489969	Enquiry
40-25	60	38	41	23	29x1,5			489970	Enquiry
40-32	60	38	41	23	35x1,5			489971	Enquiry
50-15	80	50	53	30	19x1,5			489934	Enquiry
50-20	80	50	53	30	23x1,5			489935	Enquiry
50-25	80	50	53	30	29x1,5			489972	Enquiry
50-32	80	50	53	30	35x1,5			489973	Enquiry
50-40	80	50	53	30	41x1,5			489974	Enquiry
65-25	105	66	70	40	29x1,5			489975	Enquiry
65-32	105	66	70	40	35x1,5			489976	Enquiry
65-40	105	66	70	40	41x1,5			489977	Enquiry
65-50	105	66	70	40	53x1,5			489978	Enquiry
80-25	130	81	85	47,5	29x1,5			489979	Enquiry
80-32	130	81	85	47,5	35x1,5			489980	Enquiry
80-40	130	81	85	47,5	41x1,5			489981	Enquiry
80-50	130	81	85	47,5	53x1,5			489982	Enquiry
80-65	130	81	85	47,5	70x1,5			489983	Enquiry
100-50	155	100	104	58	53x1,5			489984	Enquiry
100-65	155	100	104	58	70x1,5			489985	Enquiry
100-80	155	100	104	58	85x1,5			489986	Enquiry

Similar to DIN 11865